

SIDES	BOTTOM
4 1/2" KNOCKOUTS	1 Ground Hump
4 3/4" KNOCKOUTS	
1 PCS #10-32×3/8 Screws Installed	
2 PCS #8-32×1/2 Screws Installed	
Material: Steel-0.0625"-G60 Galvanized	

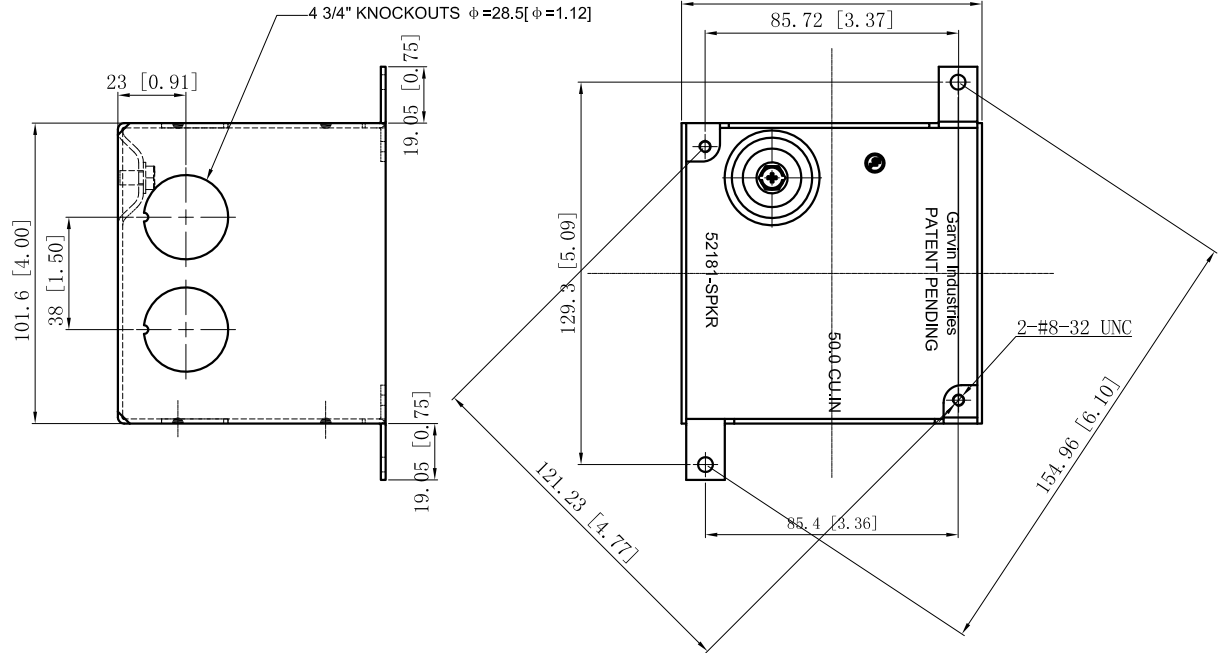
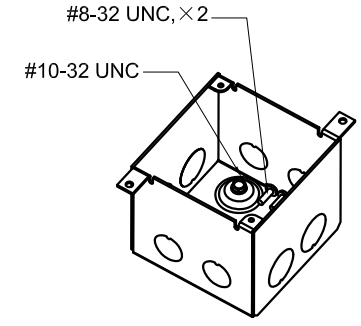
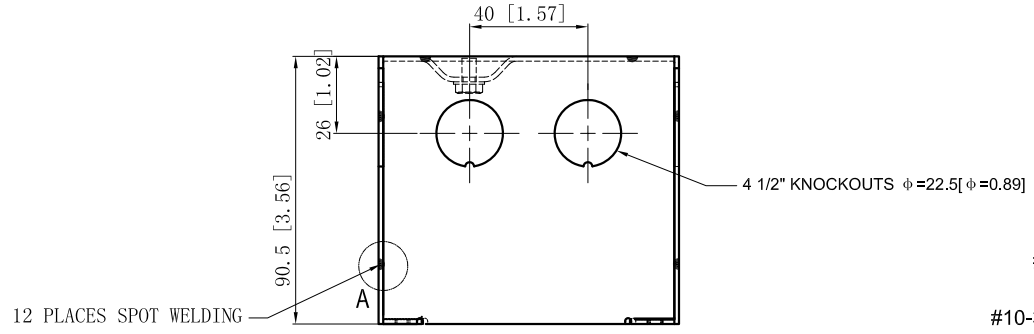

This data sheet is for reference only .GARVIN INDUSTRIES reserves the right to make changes to the design without prior notice.

DESCRIPTION
TRADE REFERENCE TERMS

STANDARD PACKING	TITLE		
	4" SQUARE BOXES 3-1/2" DEEP		
25 PCS	SIZE	DWG NO.	REV
	A4	52181-SPKR	
DATA SHEET			

GARVIN INDUSTRIES