

SIDES	BOTTOM
2 1" KNOCKOUTS	3 1/2" KNOCKOUTS
2 3/4" KNOCKOUTS	2 3/4" KNOCKOUTS
4 1/2"-3/4" KNOCKOUTS	1 GROUD HUMP
2 PCS #8-32×1/2 Screws Installed	
Material:Steel-0.0625"-G60 Galvanized	

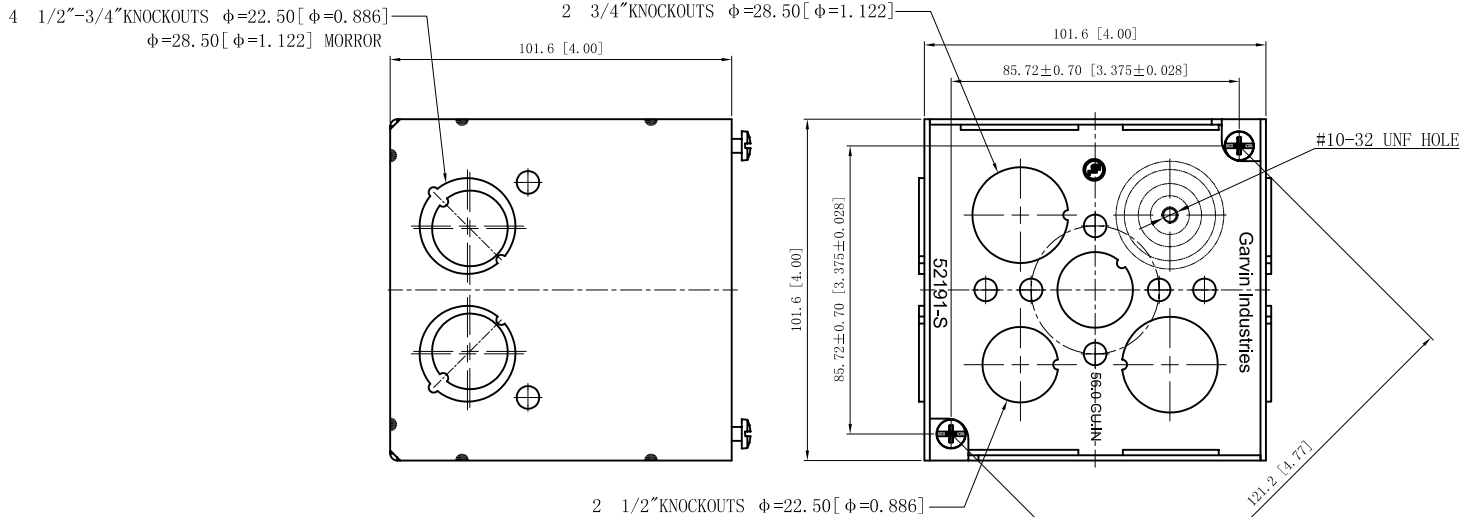
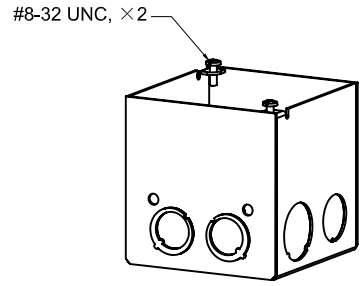
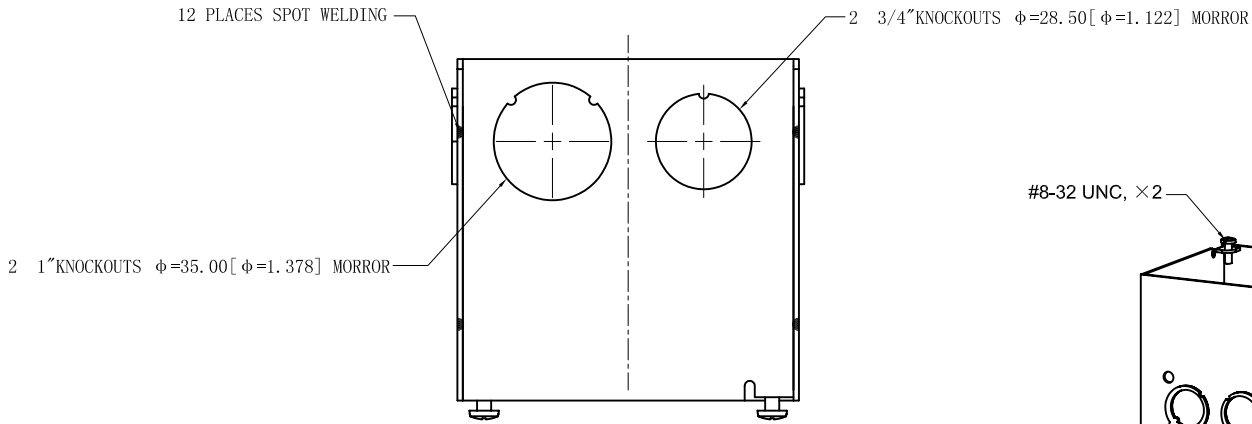

This data sheet is for reference only .GARVIN INDUSTRIES reserves the right to make changes to the design without prior notice.

DESCRIPTION
TRADE REFERENCE TERMS

STANDARD PACKING	<h1 style="text-align: center;">GARVIN INDUSTRIES</h1>			
10 PCS				TITLE
	SIZE	DWG NO.	REV	
	A4	52191-S		
		DATA SHEET		