

SIDES	BOTTOM
20 1/2"-3/4" KNOCKOUTS	6 1/2" KNOCKOUTS
	4 3/4" KNOCKOUTS
4 PCS 8-32x1/2 Screws Installed	
Material: Steel-0.0625"-G60 Galvanized	

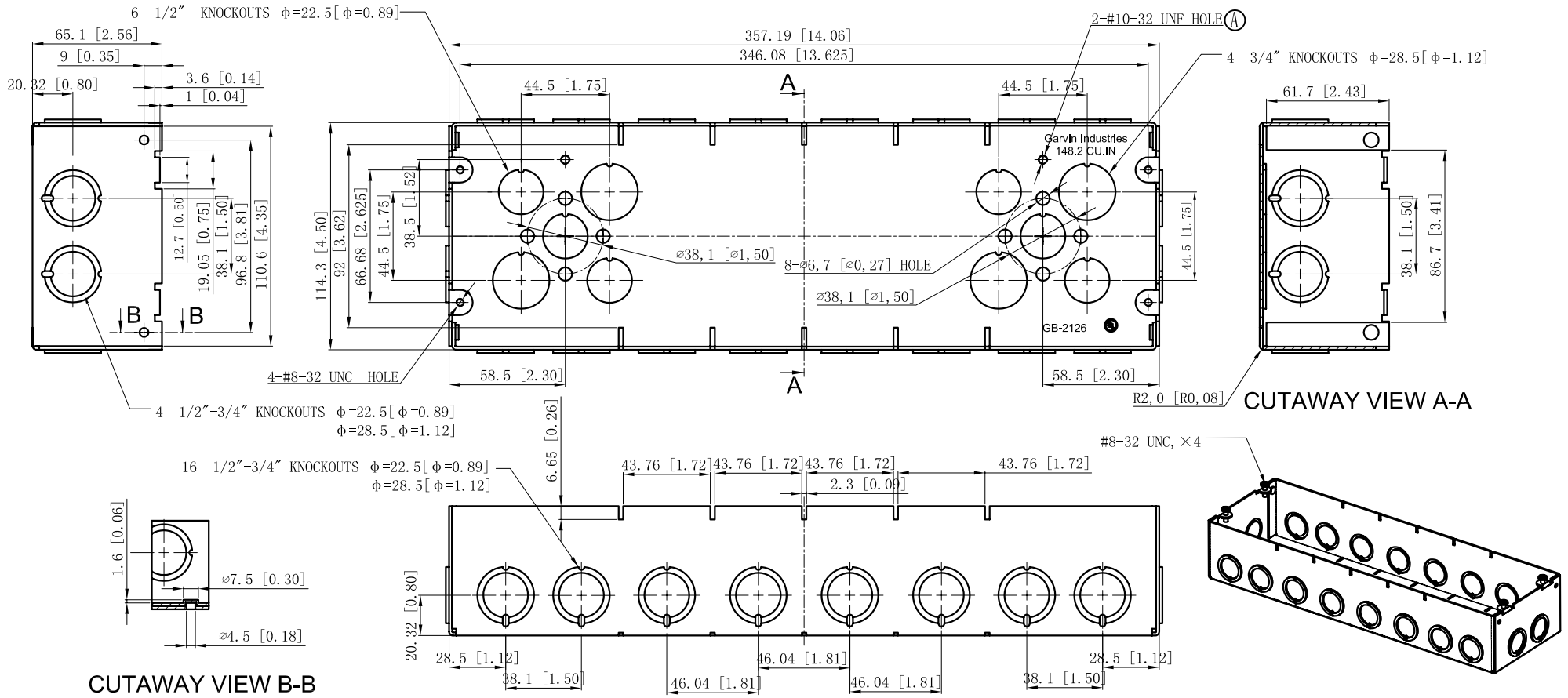

DESCRIPTION
TRADE REFERENCE TERMS

This data sheet is for reference only .GARVIN INDUSTRIES reserves the right to make changes to the design without prior notice.

STANDARD PACKING	GARVIN INDUSTRIES		
	2-1/2" DEEP MULTI-GANG BOXES		
5 PCS	TITLE	GB-2126	
	SIZE	DWG NO.	REV
	A4		A
DATA SHEET			